



Ergonomics • Features • Benefits



Lockable Volume

Gilson's patented volume locking system guarantees no accidental volume changes while pipetting. If you forget to lock your volume, simply completing your first pipetting cycle will lock it!

Redesigned Handle

This ergonomic pipette is designed to provide all day pipetting comfort. The redesigned handle is lightweight and the finger hook provides added comfort. The textured body makes it easy to hold onto, even when wearing gloves.

Balanced Weight

Not too heavy, not too light. The PIPETMAN L balances comfortably in your hand without creating extra fatigue for your daily pipetting routines.

Universal Tip Holder

Unique tip holder design allows for a secure fit of most brands of tips, so there's no need for a dedicated tip brand.

Adjustable Tip Ejector Button

A wider, convex button shape provides a larger resting area for your thumb and is suitable for both right- and left-handed users. Ejecting tips is now up to 50% easier versus the PIPETMAN Neo.

Extremely Low Pipetting Forces

PIPETMAN L offers a new piston assembly that drastically improves the pipetting and purge forces (up to 50% when compared to the PIPETMAN Neo) thanks to a new seal, lighter springs, and the addition of high quality piston grease.

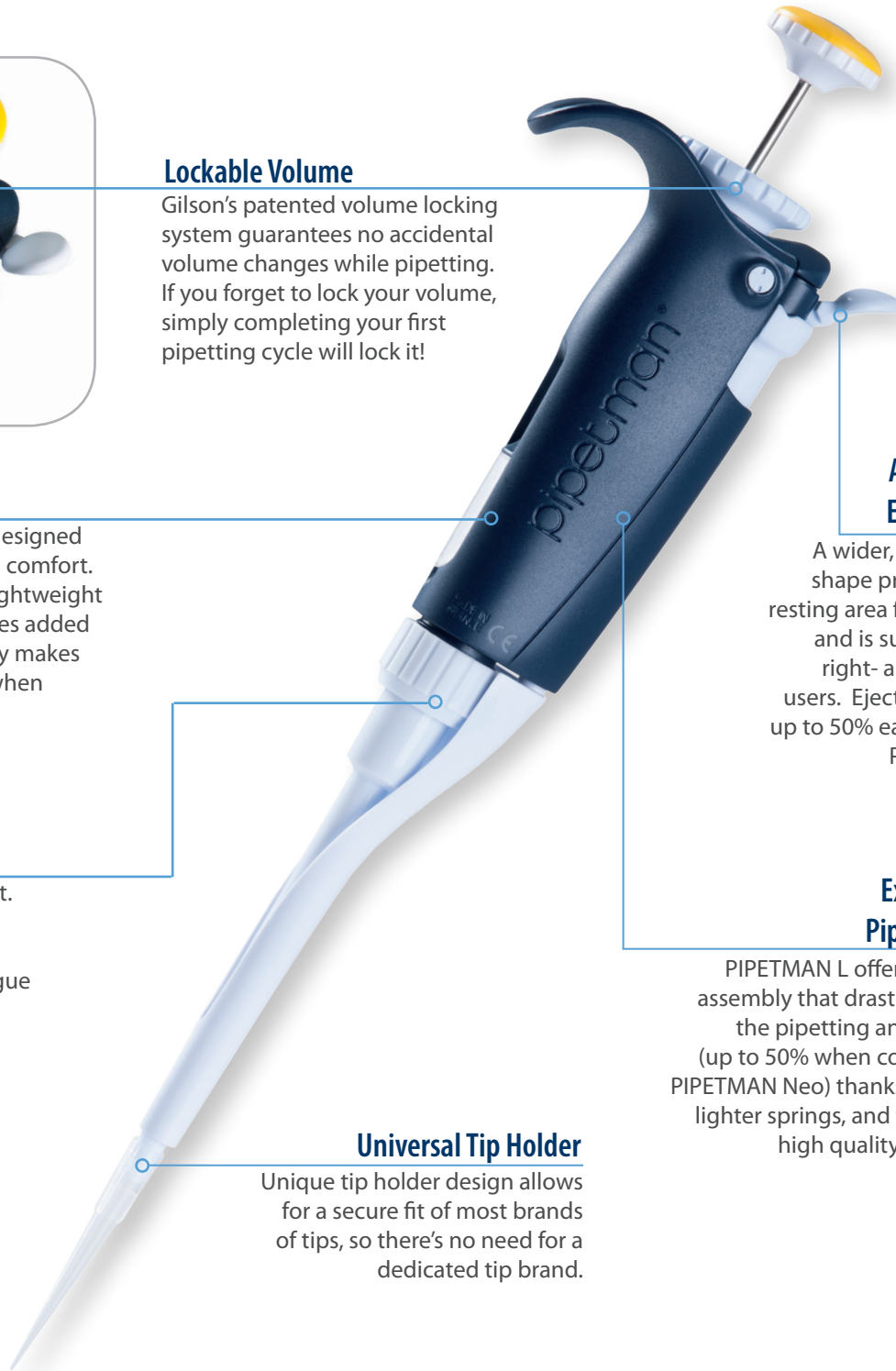

Take Comfort To The Next Level

Extremely Low Pipetting Forces. Newly engineered, low-force springs and high quality grease reduce pipetting forces by 50% when compared to the PIPETMAN Neo for standard volumes. The P5000L and P10mL L are reduced by 40% over the PIPETMAN Classic™. In addition to the new springs, this product features a new seal holder and o-ring for enhanced pipetting comfort.

Enjoy a comfortable, lightweight pipette that has been designed to fit naturally in your hand. Its new shape ensures a perfect fit while the new hook reduces tensions while holding it.

Optimum Traceability

2D Identification Code for Easy Traceability. Keep track of maintenance records easily with this 2D barcode. This barcode provides the product reference number, the date of manufacture, the serial number and the maximum volume of the pipette. Use any 2D Data Matrix scanner to download the pipette information into an Excel spreadsheet or your own software for enhanced GLP compliance.



Lockable Volume in 3 Easy Steps:



1
Just push the thumbwheel up,



2
rotate to change the volume,



3
push the thumbwheel down to lock it and start pipetting!

Improved Tip Ejector Button

Effortless Tip Ejection. A new shape and new mechanism for the tip ejection system dramatically reduces the tip ejection forces by up to 50% over the PIPETMAN Neo. Before you pipette, you can adjust the tip ejector button according to your preferences (to the right, in the middle, or to the left) by simply rotating the button.



Comfortable Tip Ejection - You Choose!

Either push the tip ejector button with the tip of your thumb (Figure 1) or with the base of your thumb (Figure 2).

 **GILSON®**