

pipetman[®]

L

Precision, Comfort, and Reliability Engineered for Everyday Lab Performance

PIPETMAN[®] L is designed to reduce hand fatigue and increase productivity. Its lightweight, perfectly balanced design and low pipetting forces help you stay focused, even during long pipetting sessions.

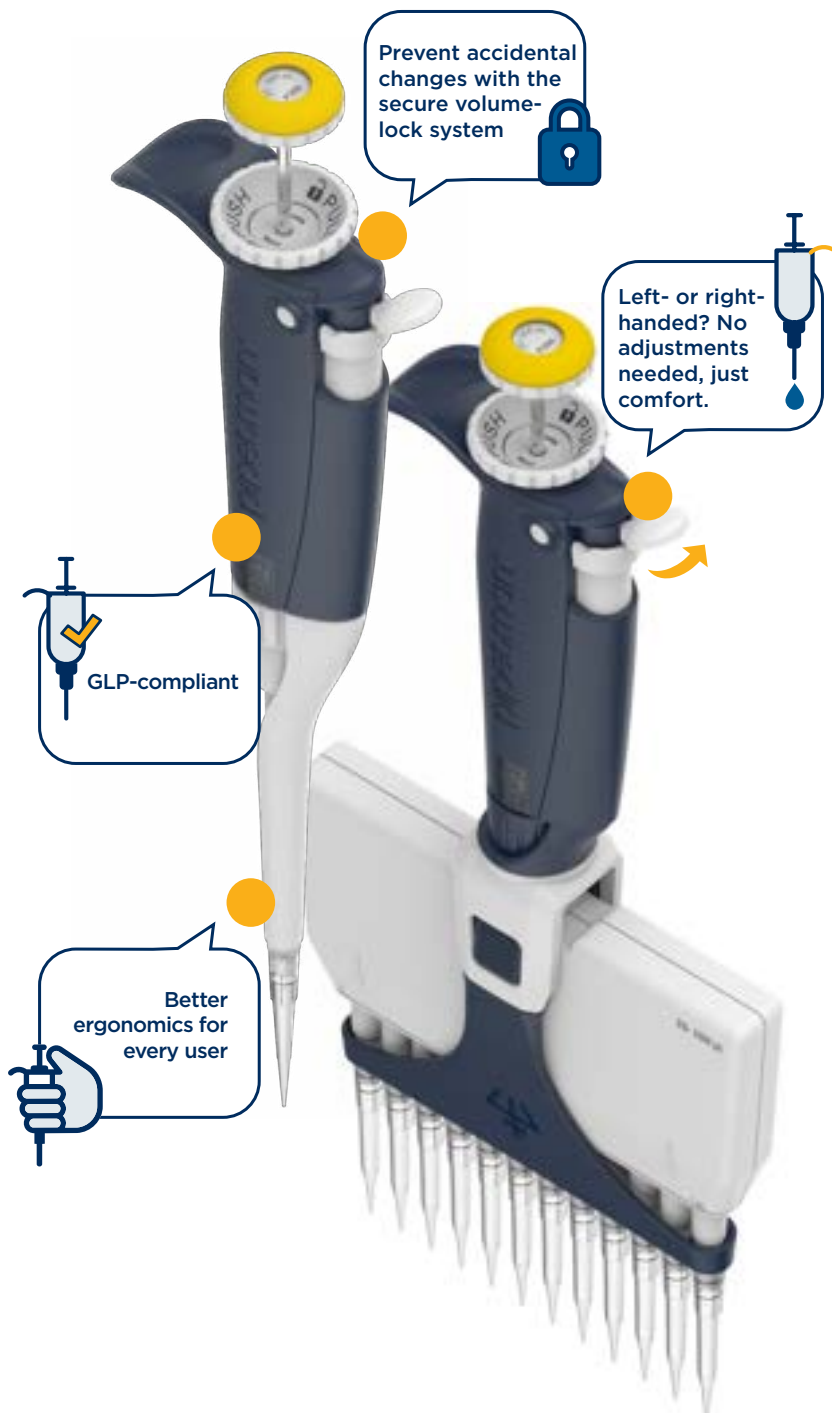

Work Longer Without Fatigue

- Reduced risk for RSIs
- More consistent results over time
- Higher daily throughput

Confidence in Every Pipetting Step

- Reliable, reproducible results you can trust
- Secure volume locking to prevent accidental changes
- Confidence when it matters most in critical experiments
- Fully autoclavable for better protection against cross-contamination

The Right Solution for Every Task

- Broad volume range: 0.2 μ L to 10 mL in single channel models
- Multichannel options up to 1200 μ L for flexible protocol support
- Fixed-volume models for consistent, repeatable tasks
- Multichannel V-ring design on select models enhances tip fit across most brands



An ideal solution for Biotechs, clinical labs, and high-intensity routine environments

 **GILSON[®]**

| PIPETMAN L Single Channel — Variable Volume Models | | | | |
|--|------------------------|----------------------|-------------|--------------|
| Model | PIPETMAN® DIAMOND Tips | | Part Number | Volume (µL) |
| P2L | D10 DL10 | DF10ST DFL10ST | FA10001P | 0.2 - 2 |
| | | | FA10001M | |
| P10L | D10 DL10 | DF10ST DFL10T | FA10002P | 0.5 - 10 |
| | | | FA10002M | |
| P20L | D200 | DF30ST | FA10003P | 2 - 20 |
| | | | FA10003M | |
| P100L | D200 | DF100ST | FA10004P | 10 - 100 |
| | | | FA10004M | |
| P200L | D200 D300 | DF200ST DF300ST | FA10005P | 20 - 200 |
| | | | FA10005M | |
| P1000L | D1000 D1200 | DF1000ST DF1200ST | FA10006P | 100 - 1000 |
| | | | FA10006M | |
| P5000L | D5000 | | FA10007 | 500 - 5000 |
| P10mLL | D10mL | | FA10008 | 1000 - 10000 |



SCAN ME!

Ready to upgrade your pipetting experience?

*For a pipette with a plastic tip ejector, the part number ends with the letter P. For a pipette with a stainless steel tip ejector, the part number ends with the letter M, from P2L to P1000L.

| PIPETMAN L Multichannel Models | | | | |
|--------------------------------|------------------------|--------------------|-------------|-------------|
| Model | PIPETMAN® DIAMOND Tips | | Part Number | Volume (µL) |
| P8x10L | D10 DL10 | DF10ST DFL10ST | FA10013 | 0.5 - 10 |
| P12x10L | | | FA10014 | |
| P8x20L | DL10 D200 | DFL10ST DF30ST | FA10009 | 2 - 20 |
| P12x20L | | | FA10010 | |
| P8x200L | D200 D300 | DF200ST DF300ST | FA10011 | 20 - 200 |
| P12x200L | | | FA10012 | |
| P8x200LVR** | D200 D300 | DF200ST DF300ST | FA10035 | 20 - 200 |
| P12x200LVR** | | | FA10036 | |
| P8x300L | D200 D300 | DF200ST DF300ST | FA10015 | 20 - 300 |
| P12x300L | | | FA10016 | |
| P8x300LVR** | D200 D300 | DF200ST DF300ST | FA10037 | 20 - 300 |
| P12x300LVR** | | | FA10038 | |
| P8x1200L | D1200 | DF1200ST | FA10039 | 100 - 1200 |
| P12x1200L | | | FA10040 | |



**Models equipped with V-rings.

| PIPETMAN® L KITS | | | | |
|-----------------------------|-------------|--------------------------------|------------------------|---|
| Model | Part Number | PIPETMAN L Models | PIPETMAN® DIAMOND Tips | Accessories |
| PIPETMAN L Starter Kit | F167350 | P20L P200L P1000L | D200 D1000 | 3 SINGLE™ pipette holders 3 plastic ejectors |
| PIPETMAN L Micro-volume Kit | F167550 | P2L P10L P100L | DL10 D200 | 3 SINGLE™ pipette holders 3 plastic ejectors |
| PIPETMAN L 4-Pipette Kit | F167370 | P2L P20L P200L P1000L | DL10 D200 D1000 | 4 SINGLE™ pipette holders 4 Plastic ejectors |

Choose your Tip Ejector

For single channel models, choose between a model with a stainless-steel tip ejector or a plastic ejector* depending on your needs and applications.

Large volume models are equipped with a plastic tip ejector to avoid any direct contact with the tip.

Choose Your Model

For routine testing applications, PIPETMAN L is available in fixed-volume models*** from 1 µL to 5 mL, helping reduce the risk of volume errors and ensure consistent results. With the same lightweight, ergonomic design, it's a reliable choice even for non-trained lab technicians.

***PIPETMAN L Fixed models are not fully autoclavable.

PIPETMAN L single channel models are available in kits, offering the essential pipetting tools to start an experiment right away.



PIPETMAN DIAMOND® Tips are designed to fit your PIPETMAN perfectly and guarantee maximum accuracy and precision.

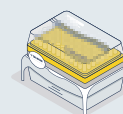

For ordering information, visit www.gilson.com

gilson.com/contactus

LT800606/C | ©2026 Gilson S.A.S.
All rights reserved. All trademarks are the property of Gilson, Inc. and its subsidiaries.

GILSON®